



- Please **READ** these instructions first, it only takes a few minutes.
- This sheet explains how to use the tools and explains the symbols used in the project instructions.
- You can also go to [www.megaconstruction.co.uk](http://www.megaconstruction.co.uk) to see a video of how to use the tools and watch each model being built up piece by piece which you can pause and rewind.



All the tools are completely safe and are designed for cutting foam tubes.

The models are made up from 3 tube sizes, you will see these referred to as **L** for large, **M** for Medium and **S** for small.

## TOOLS

### MEASURE

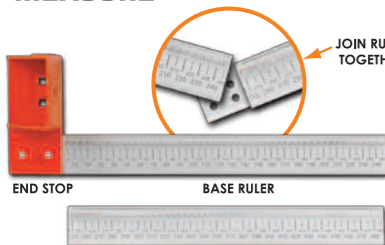

### SAW CUTTING

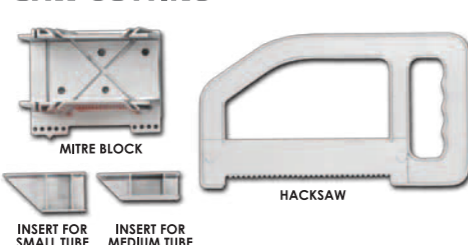

### HOLE CUTTING



### SLOT PUNCHING



## SAW CUTTING

### L LARGE TUBES

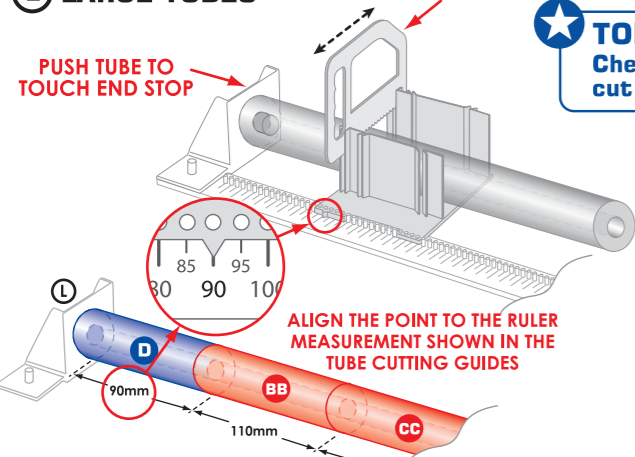

### M MEDIUM TUBES

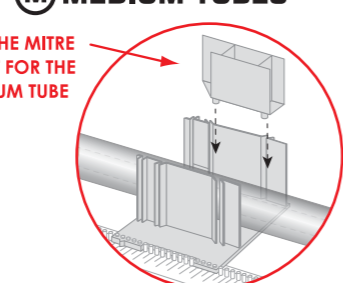

### S SMALL TUBES

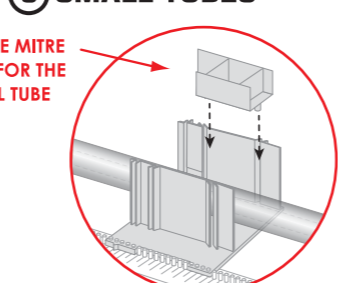

- When cutting, hold the tube steady with your free hand.
- On the back of this sheet you will find the tube cutting guide for your project.
- Before cutting each length, **DOUBLE CHECK** you have the right size tube and the pointer is at the correct measurement.
- Put the corresponding sticker on the end of the tube after each piece is cut.

## HOLE CUTTING - MATCH THE ORANGE AND BLACK COLOUR TOOLS TO THE INSTRUCTIONS

### L LARGE TUBES

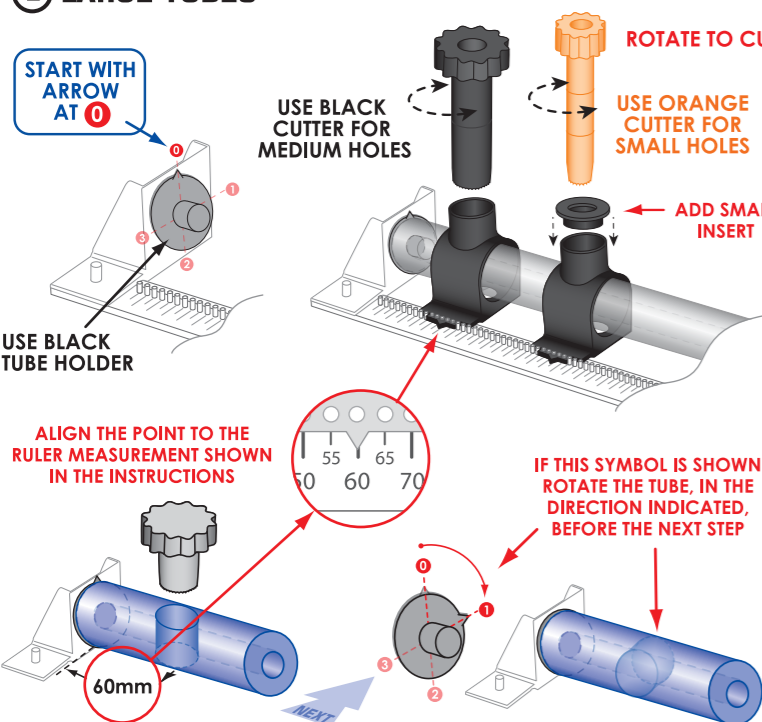

### M MEDIUM TUBES

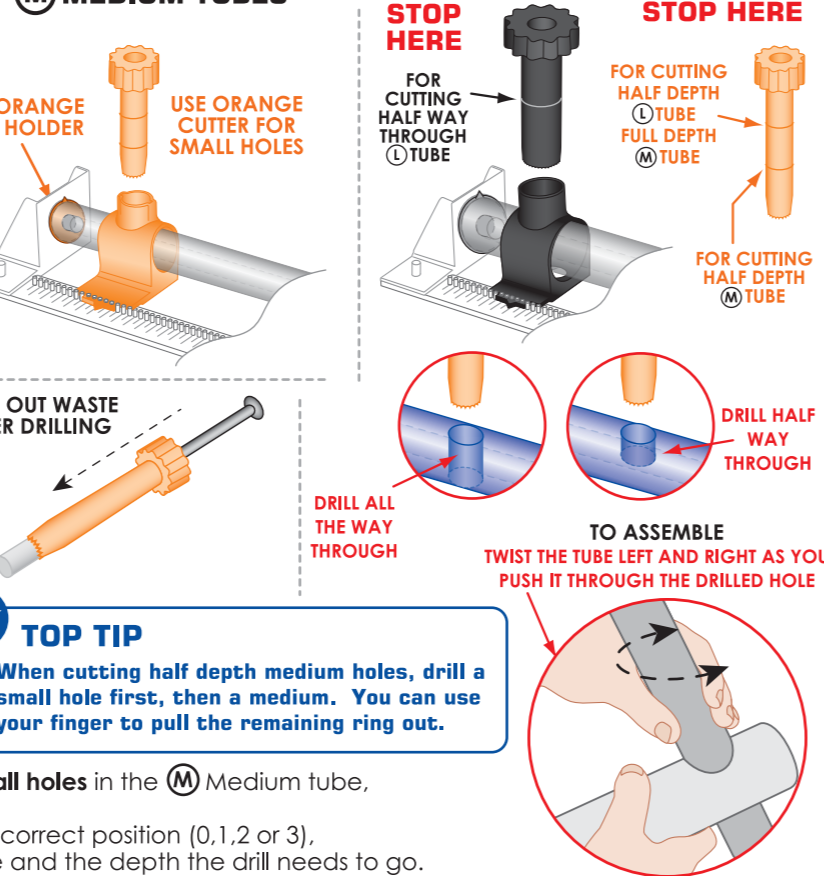

- You can drill **Medium** and **Small** holes in the **L** Large tube and **only small holes** in the **M** Medium tube, you **CANNOT** drill holes in the **S** Small tube.
- Before you cut each hole **DOUBLE CHECK** the tube holder arrow is in the correct position (0,1,2 or 3), the pointer is on the correct measurement, you have the correct drill size and the depth the drill needs to go.

## PUNCHING SLOTS

### L LARGE TUBES

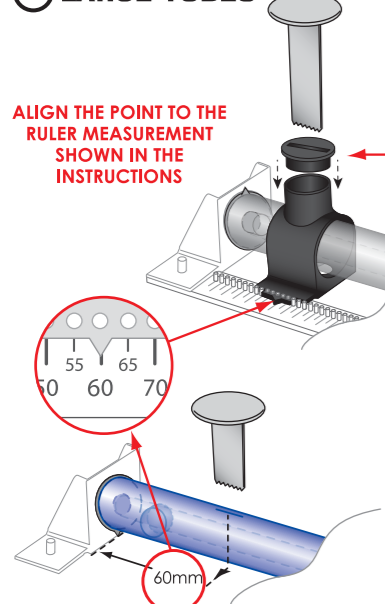

### M MEDIUM TUBES

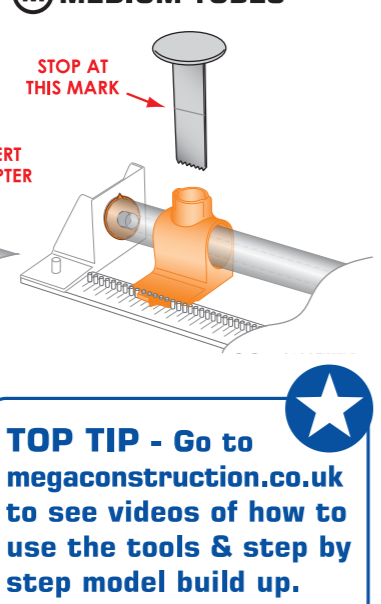

## CARD PIECES

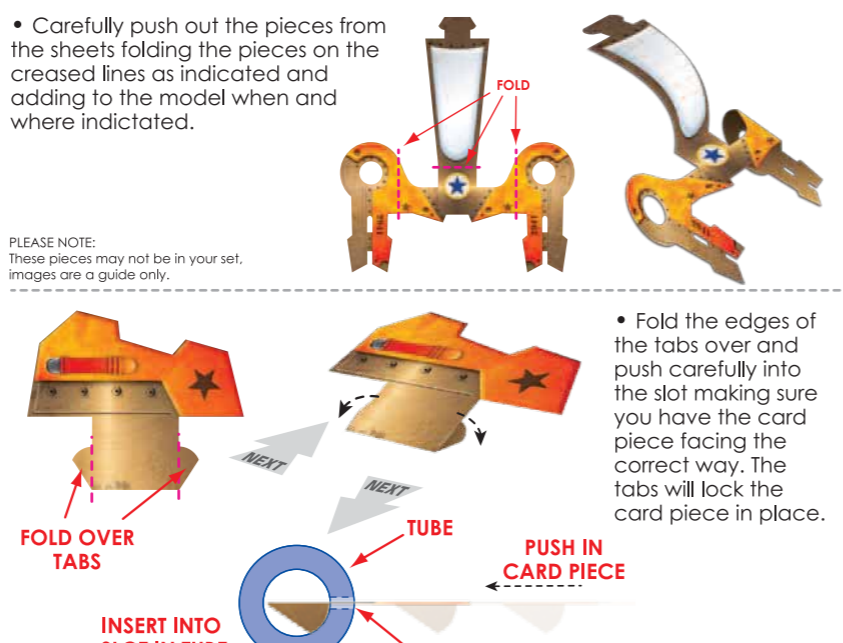

## HELICOPTER

### TUBE CUTTER GUIDE - START YOUR PROJECT BY CUTTING THE TUBES

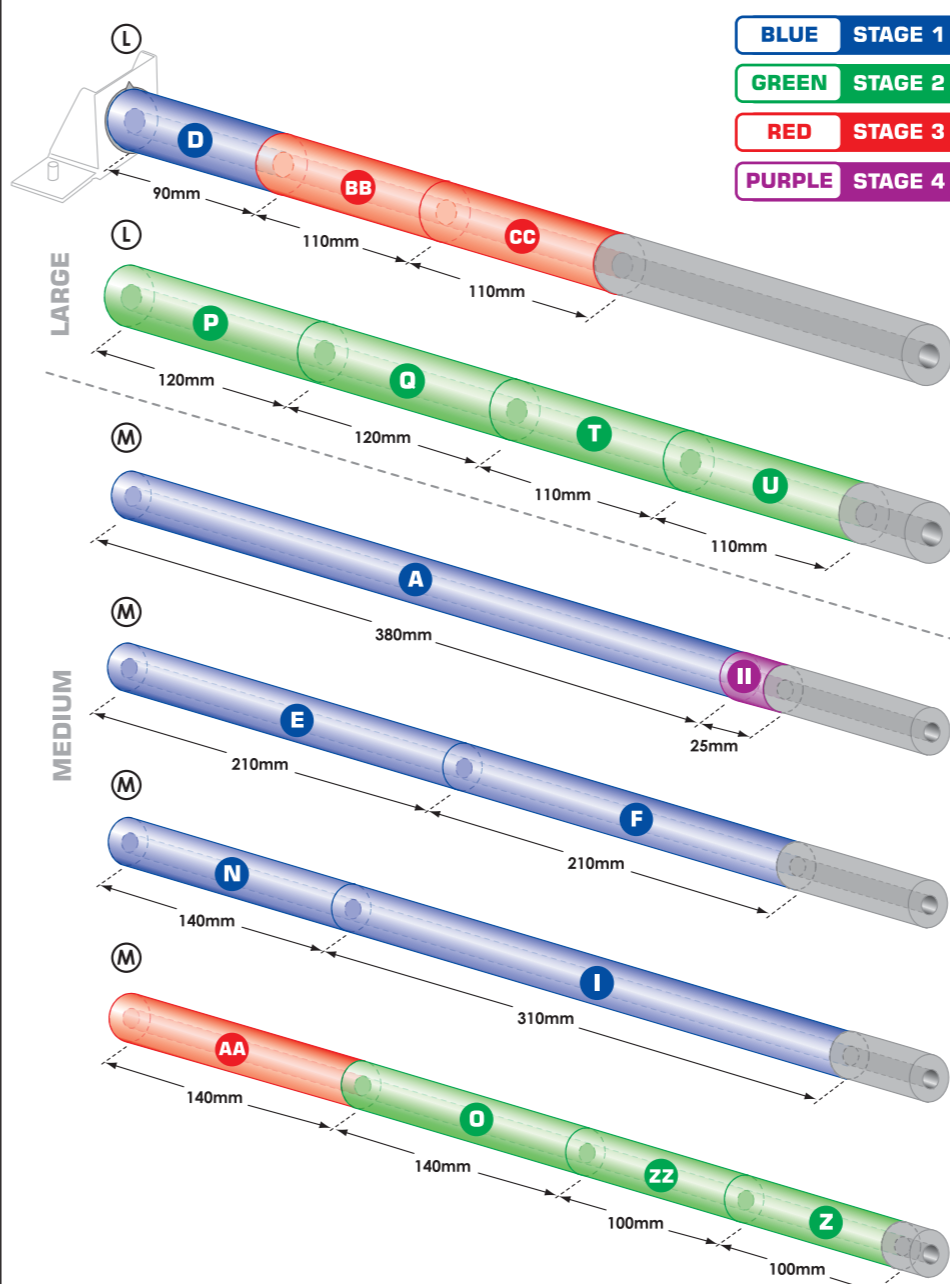

- Cut all tubes to the correct length as shown here.
- Use each size & length as indicated to ensure you don't run out of tube.
- Place a sticky label on each corresponding tube (after each cut) as you will need this reference when it comes to the construction of your model.
- Divide your tubes into 4 piles according to colour of sticker, these relate to the 4 stages, as you will not need all the tubes at once.
- Alternatively you can cut the tube for each stage at the time of construction but you will need to remember which tube has been cut. The best way to remember is to put the sticker of the next piece to be cut on the end of the remaining tube.

## PARTS



## ROBOT

### TUBE CUTTER GUIDE - START YOUR PROJECT BY CUTTING THE TUBES



- Cut all tubes to the correct length as shown here.
- Use each size & length as indicated to ensure you don't run out of tube.
- Place a sticky label on each corresponding tube (after each cut) as you will need this reference when it comes to the construction of your model.
- Divide your tubes into 4 piles according to colour of sticker, these relate to the 4 stages, as you will not need all the tubes at once.
- Alternatively you can cut the tube for each stage at the time of construction but you will need to remember which tube has been cut. The best way to remember is to put the sticker of the next piece to be cut on the end of the remaining tube.

## PARTS



WARNING: Not suitable for children under 36 months. Choking hazard - can form small parts. Adult supervision required. Only use the tools as instructed. Never use real saws, drills or other cutting devices.

John Adams are constantly endeavouring to improve quality standards and therefore colours, sizes and contents may sometimes vary from those shown.

©2013 John Adams Leisure Ltd. Please retain this information. Manufactured in China. John Adams Leisure Ltd., Marketing House, Blackstone Road, Huntingdon, Cambs, PE29 6EF, UK. Customer Service Tel: 01480 414361 or Email [customerservices@johnadams.co.uk](mailto:customerservices@johnadams.co.uk). To see more of our range why not visit [www.johnadams.co.uk](http://www.johnadams.co.uk)